

THIS SPACE FOR DESIGNER/ENGINEER APPROVAL

Job/Customer _____	Date _____	Contractor _____
Model Specified _____	Qty _____	Approved By _____
Designer/Engineer _____	Date _____	Contractor's PO# _____
Submitted by _____	Date _____	Other _____

2699W Series
In-Line Spring Check Valve
Forged Dezincification Resistant Brass
For Connection to Copper, CPVC, or PEX
Lead Free
Push x Push
200 PSI / 200 ° F Max
ISO 9001

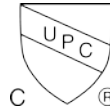

Certified to
 ASSE 1061
 & NSF/ANSI 61-G

ITEM #	SIZE	CTN	CASE	A	B	C
26993W	3/4"	12	120	1 3/8	3/4	3 3/16



NO.	DESCRIPTION	MATERIAL
1	INNER LINING	PLASTIC
2	PROTECTOR	PLASTIC
3	PUSH RING	PLASTIC
4	GRIP RING	STAINLESS STEEL 304
5	LOCK RING	PLASTIC
6	"O" RING	EPDM
7	CHECK VALVE	PLASTIC
8	BODY	BRASS

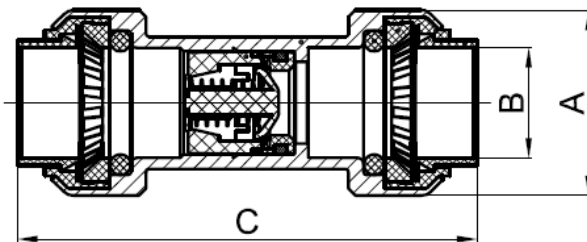

TEMP °F	PSI
100	200
150	200
200	200
250	N/A
300	N/A
350	N/A
366	N/A

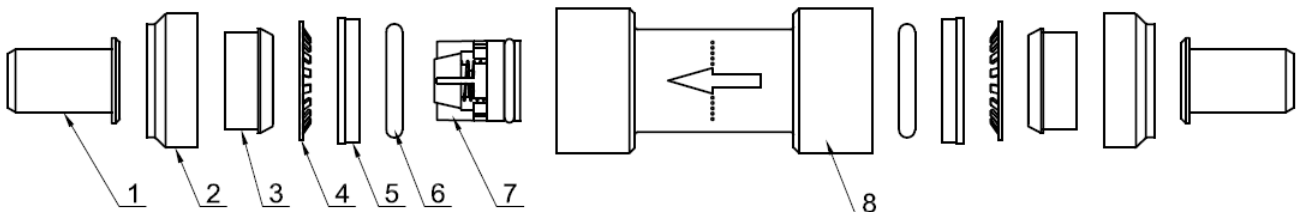

Specifications: Designed for residential, commercial or industrial use with water, specifically for use in copper, CPCV, or PEX systems. This product features a fully removable grip assembly.



Quality and Commitment Since 1954

www.webstonevalves.com · P: (800) 225-9529 · F: (800) 336-5133

Webstone product specifications in U.S. customary units are approximate and are provided for reference only. Webstone reserves the right to change or modify product design, construction, specifications or materials without prior notice and without incurring any obligation to make such changes and modifications on Webstone products previously or subsequently sold.

2699Wspec_091013