

THIS SPACE FOR DESIGNER/ENGINEER APPROVAL

Job/Customer _____	Date _____	Contractor _____
Model Specified _____	Qty _____	Approved By _____
Designer/Engineer _____	Date _____	Contractor's PO# _____
Submitted by _____	Date _____	Other _____

1153-E Series
Brass Union Elbows & Nuts for Radiator Valves
w/ Ground Joint Connection
FIP x MIP
60 PSI / 15 WSP
ISO 9001

ITEM #	SIZE	CTN	CASE	A	B
11533-E	3/4"	10	100	2 1/2	1 5/16
11534-E	1"	7	70	2 7/8	1 3/8
11535-E	1 1/4"	5	50	3 3/8	1 3/4

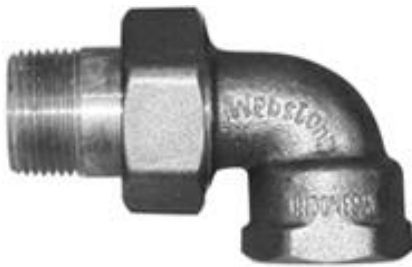

NO.	DESCRIPTION	MATERIAL
1	NIPPLE	BRASS
2	NIPPLE NUT	BRASS
3	BODY	BRASS

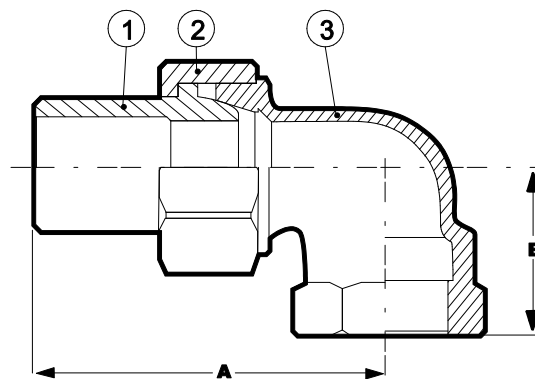

Specifications: Designed for residential or commercial use with approved brass radiator valves in steam and hot water heating systems. Allows for easy removal or relocation of hydronic radiators. Threaded ends comply with ANSI B1.20.1.



Quality and Commitment Since 1954

www.webstonevalves.com · P: (800) 225-9529 · F: (800) 336-5133

Webstone product specifications in U.S. customary units are approximate and are provided for reference only. Webstone reserves the right to change or modify product design, construction, specifications or materials without prior notice and without incurring any obligation to make such changes and modifications on Webstone products previously or subsequently sold.

1153Espec_090711